

Pei Evaluation Service® is an accredited ISO Standard 17065 Product Certifier, accredited by the IAS. This **Product Evaluation Report** represents a product that **Pei ES** has Evaluated. This product has a Product Evaluation Service Agreement & Follow-up Inspection Service Agreement. This **Product Evaluation Report** in no way implies warranty for this product or relieves **USA Vinyl, LLC** of their liabilities for this product. This **PER** is an official document if it is within one year of the Initial or Re-Approval date.

Initial Approval
April, 2013

Re-Approved
March, 2021

See all **Pei ES** Listings at: www.p-e-i.com

Report Owner (Manufacturer)

USA Vinyl, LLC
5795 Green Pointe Drive
Groveport, OH 43125

Products

WXR-T42-A8/10	WXR-R36-R8DB	CXR-T42-E8
WXR-T42-C8/10	WXR-R36-S8DB	CXR-T42-R8
WXR-T42-R8/10	WXR-T42R3-S8/10	CXR-T42-S8
WXR-T42-S8/10	CXR-R42-A8	CXR-T42R3-S8
WXR-R42-A8/10	CXR-R42-C8	
WXR-R42-C8/10	CXR-R42-E8	
WXR-R42-R8/10	CXR-R42-R8	
WXR-R42-S8/10	CXR-R42-S8	
WXR-R36-A8DB	CXR-T42-A8	
WXR-R36-C8DB	CXR-T42-C8	

Evaluation Report Information

www.weatherables.com

USA Vinyl, LLC Contact: Jason Lott - Production Plant Manager
Phone: 1-888-743-3673
Email: jlott@weatherables.com

Legend

X	X	R	X	XX	X	X	X
1	2	3	4	5	6	7	8

1. Bracket Style - (C = 1 piece) (W = 2 piece)
2. Color: (W = White), (T = Tan), (K = Khaki), (B = Textured Black)
3. Railing: (Static) ("R" only)
4. Top Rail: (R = Rectangle) (T = T-Rail)
5. Railing Height / Mid-Rail: (36" or 42") (R3 = 3-Rail)
6. Spindle: (A = Alum. Square Spindle), (C = Colonial), (E = Rectangular), (R = Round Aluminum), (S = Square)
7. Width: (4-ft, 6-ft, 8-ft & 10-ft)
8. Optional: (S = Stair Railing)

General Details

The **USA Vinyl, LLC** guardrails are used for exterior guards for balconies, porches, stairs and decks. The top and bottom railings are manufactured with openings spaced under 4-in to accommodate the vertical balusters.

The guardrails have been tested and evaluated for structural strength to meet design loads and requirements of the building codes listed under the Code Compliance section of this **PER**. The post and post anchorage requirements are outside the scope of this report.

Product Descriptions

The **USA Vinyl, LLC** guardrail parts are co-extruded using a Polyvinyl Chloride Resin (PVC). Three colors are offered, white, tan and khaki. The guardrails are designed for a maximum installed height of 42-in with a maximum length of 96-in or 120-in when measured between posts. Each post is a vinyl sleeve over a 4-in x 4-in timber. The top rails are strengthened with .065-in, .075-in or .100-in thick extruded aluminum rail reinforcement. The bottom rails are either supported by crush blocks or use of an aluminum rail reinforcement. The rails are attached to the posts using a specific bracket and stainless steel screws. The pickets are placed in the pre-cut holes in the rails. The holes are cut for a tight fit. See the figures shown on pages 3 through 10 for exact specifications and requirements for each model of guardrail.

General Product Usage

1. The **USA Vinyl, LLC** guardrail systems shall be installed in accordance with the Classic Straight Railing, Classic Stair Railing, Premium Straight Railing, Premium Stair Railing and Premium Deck Board Railing Installation Instructions supplied by **USA Vinyl, LLC** and the conditions of this **PER**. A copy of the Installation Instructions noted earlier shall be made easily available to the installer.
2. All framing, wood posts, beams, joists, stringers and associated connections needed to support the **USA Vinyl, LLC** guardrails are outside the scope of this **PER**. All framing shall follow applicable codes or be designed by a licensed Engineer. Stairway handrails shall be designed and constructed in accordance with the applicable codes.
3. All **USA Vinyl, LLC** guardrails shall be fastened to wood framing in accordance with the bracket systems described in Table 1 and the figure on page 4 through 15 accordingly. Crush blocks shall be fastened to the bottom rail and to 1-in thick minimum treated lumber deck board using (2) #8 x 1-in long stainless steel wood screws unless otherwise noted.
4. The pre-cut holes in the rails shall not be altered or made larger. The tight fit is important to the integrity of the assembly.

Code Compliance for Handrails & Guardrail Systems

2012 International Residential Code		2012 International Building Code		
Section R301.5	Section R312.1	Section 1013.2	Section 1013.3	Section 1013.4
Section R317.4		Section 1013.5	Section 1013.6	Section 1013.7
		Section 1607.8.1		
2015 International Residential Code		2015 International Building Code		
Section R301.5	Section R312.1	Section 1015.2	Section 1015.3	Section 1015.4
Section R317.4	Section R507.3	Section 1015.5	Section 1015.6	Section 1015.7
		Section 1607.8.1	Section 2612	

1. Meets IBC & IRC requirements only if installation as product was tested. See Table 1 and Figure 1 through Figure 16 for details
2. Limited to Type V-B construction

Table 1 - Model Specific Code Compliance

Product Code ^{1,2}	2015		2012		Aluminum Channel in Top Rail Required	Aluminum Channel in Bottom Rail Required ⁴	Brackets Allowed
	IRC	IBC	IRC	IBC			
WXR-T42-A8	X	X	X	X	Yes - .065" or .075"	Yes - .065" or .075"	LMT 1422-CM or 1520-WP
WXR-T42-A10	X	X ³	X	X ³	Yes - .075" or .100" ⁶	Yes - .065", .075" or .100"	LMT 1422-CM or 1520-WP
WXR-T42-C8	X	X	X	X	Yes - .065" or .075"	No ⁴	LMT 1422-CM or 1520-WP
WXR-T42-C10	X	X ³	X	X ³	Yes - .075" or .100" ⁶	No ⁴	LMT 1422-CM or 1520-WP
WXR-T42-R8	X	X	X	X	Yes - .065" or .075"	Yes - .065" or .075"	LMT 1422-CM or 1520-WP
WXR-T42-R10	X	X ³	X	X ³	Yes - .075" or .100" ⁶	Yes - .065", .075" or .100"	LMT 1422-CM or 1520-WP
WXR-T42-S8	X	X	X	X	Yes - .065" or .075"	No ⁴	LMT 1422-CM or 1520-WP
WXR-T42-S10	X	X ³	X	X ³	Yes - .075" or .100" ⁶	No ⁴	LMT 1422-CM or 1520-WP
WXR-R42-A8	X	X	X	X	Yes - .065" or .075"	Yes - .065" or .075"	LMT 1422-CM or 1520-WP
WXR-R42-A10	X	X	X	X	Yes - .100"	Yes - .065", .075" or .100"	LMT 1422-CM
WXR-R42-C8	X	X	X	X	Yes - .065" or .075"	No ⁴	LMT 1422-CM or 1520-WP
WXR-R42-C10	X	X	X	X	Yes - .100"	No ⁴	LMT 1422-CM
WXR-R42-R8	X	X	X	X	Yes - .065" or .075"	Yes - .065" or .075"	LMT 1422-CM or 1520-WP
WXR-R42-R10	X	X	X	X	Yes - .100"	Yes - .065", .075" or .100"	LMT 1422-CM
WXR-R42-S8	X	X	X	X	Yes - .075" or .65"	No ⁴	LMT 1422-CM or 1520-WP
WXR-R42-S10	X	X	X	X	Yes - .100"	No ⁴	LMT 1422-CM
WXR-R42-A8DB	X	X	X	X	Yes - .065" or .075"	Yes - .065" or .075"	LMT 1422-CM or 1520-WP
WXR-R42-C8DB	X	X	X	X	Yes - .065" or .075"	No ⁴	LMT 1422-CM or 1520-WP
WXR-R42-R8DB	X	X	X	X	Yes - .065" or .075"	Yes - .065" or .075"	LMT 1422-CM or 1520-WP
WXR-R42-S8DB	X	X	X	X	Yes - .065" or .075"	No ⁴	LMT 1422-CM or 1520-WP
WXR-T42R3-S8	X	X	X	X	Yes - .065" or .075"	No ⁴	LMT 1422-CM or 1520-WP
WXR-T42R3-S10	X	X ³	X	X ³	Yes - .075" or .100" ⁶	No ⁴	LMT 1422-CM or 1520-WP
CXR-R42-A8	X		X		Yes - .075"	No ⁴	LMT 1422CM, 1520-WP or 1219
CXR-R42-C8	X		X		Yes - .075"	No ⁴	LMT 1422CM, 1520-WP or 1219
CXR-R42-E8	X		X		Yes - .075"	No ⁴	LMT 1422CM, 1520-WP or 1219
CXR-R42-R8	X		X		Yes - .075"	No ⁴	LMT 1422CM, 1520-WP or 1219
CXR-R42-S8	X		X		Yes - .075"	No ⁴	LMT 1422CM, 1520-WP or 1219
CXR-T42-A8	X		X		Yes - .075"	No ⁴	LMT 1422CM, 1520-WP or 1182
CXR-T42-C8	X		X		Yes - .075"	No ⁴	LMT 1422CM, 1520-WP or 1182
CXR-T42-E8	X		X		Yes - .075"	No ⁴	LMT 1422CM, 1520-WP or 1182
CXR-T42-R8	X		X		Yes - .075"	No ⁴	LMT 1422CM, 1520-WP or 1182
CXR-T42-S8	X		X		Yes - .075"	No ⁴	LMT 1422CM, 1520-WP or 1182

Notes:

1. All railings have been tested at a height of 42-inches. Shorter railings may be installed at the same span length as long as local code requirements for railing height are met. The maximum allowable railing clear span is indicated by the last number in the product code (i.e. "8" = 8-ft clear span).
2. The second letter in the product code (X) refers to the railing color and will be labeled as follows: W=White, T=Tan, or K=Khaki.
3. Brackets must be installed with longer #10 x 2-in stainless steel screws or as noted in Table 2 when using the 1520-WP bracket. These longer screws are not provided with railing kits and shall be purchased separately by the installer.
4. Supplied footblocks shall be installed for all cases where an aluminum channel is not used in the bottom rail. See the figures as denoted throughout this report for more details.
5. For this profile, the 1422-CM bracket requires the use of the .065" aluminum top rail reinforcement when the span exceeds 8-ft.
6. Must use the .100" channel with the 1422-CM brackets for the 10-ft span.
7. See Table 2 for fastening requirements

Table 2 - Guardrail Fastening Requirements

Rail Profile ^{1,2}	Maximum Span	Connection	Bracket	Rail Reinforcement	Fastener	Qty*
WXR-R42-XX & WXR-T42-XX Series Guardrails	8'	Bracket to Post	LMT 1422-CM	0.065"	#10 x 1-1/2-in Pan-head/Phillips self-Drilling SS screws	4
		Bracket to Guardrail			#10 x 1" Pan-head/Phillips SS steel self-drilling screws	2
		Bracket to Bottom Guardrail			#10 x 1" Pan-head/Phillips SS steel self-drilling screws	2
	10'	Bracket to Post	LMT 1422-CM	0.100"	#10 x 1-1/2-in Pan-head/Phillips self-Drilling SS screws	4
		Bracket to Guardrail			#10 x 1" Pan-head/Phillips SS steel self-drilling screws	4
		Bracket to Bottom Rail			#10 x 1" Pan-head/Phillips SS steel self-drilling screws	4
	8'	Bracket to Post	1520-WP	0.075"	#10 x 2-in Pan-head/Phillips self-Drilling SS screws**	4
		Bracket to Guardrail			#10 x 1" Pan-head/Phillips SS steel self-drilling screws	4
		Bracket to Bottom Guardrail ⁴			#10 x 1" Pan-head/Phillips SS steel self-drilling screws	4
WXR-T42-X10	10'	Bracket to Post	1520-WP	0.075"	#10 x 2-in Pan-head/Phillips self-Drilling SS screws**	4
		Bracket to Guardrail			#10 x 1" Pan-head/Phillips SS steel self-drilling screws	4
		Bracket to Bottom Guardrail ⁴			#10 x 1" Pan-head/Phillips SS steel self-drilling screws	4
CXR-R42-XX & CXR-T42-XX Series Guardrails	8'	Bracket to Post	LMT 1182 / 1219	0.075"	#10 x 2-in Pan-head/Phillips self-Drilling SS screws**	6/4
		Bracket to Guardrail			#10 x 1" Pan-head/Phillips SS steel self-drilling screws	2
		Bracket to Bottom Guardrail ⁴			#10 x 1" Pan-head/Phillips SS steel self-drilling screws	2

Notes:

1. Baluster options are not included and do not affect bracket fastening. See Table 1 for Baluster options.
2. Rail profiles using "DB" or "R3" must follow fastening defined for the bracket and rail span desired, see Table 1.
3. Brackets must be installed with longer #10 x 2-in stainless steel screws or as noted in Table 2 when using the 1520-WP bracket. These longer screws are not provided with railing kits and shall be purchased separately by the installer.

* Per Bracket

** The #10 x 2-in fastener was used to the 10-ft length to for IBC use. The #10 x 1-1/2-IN can be used for anything under 10-FT spans.

WXR-T42-A8(A10), WXR-T42-C8(C10), WXR-T42-R8(R10) & WXR-T42-S8(S10)

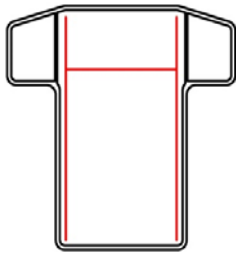
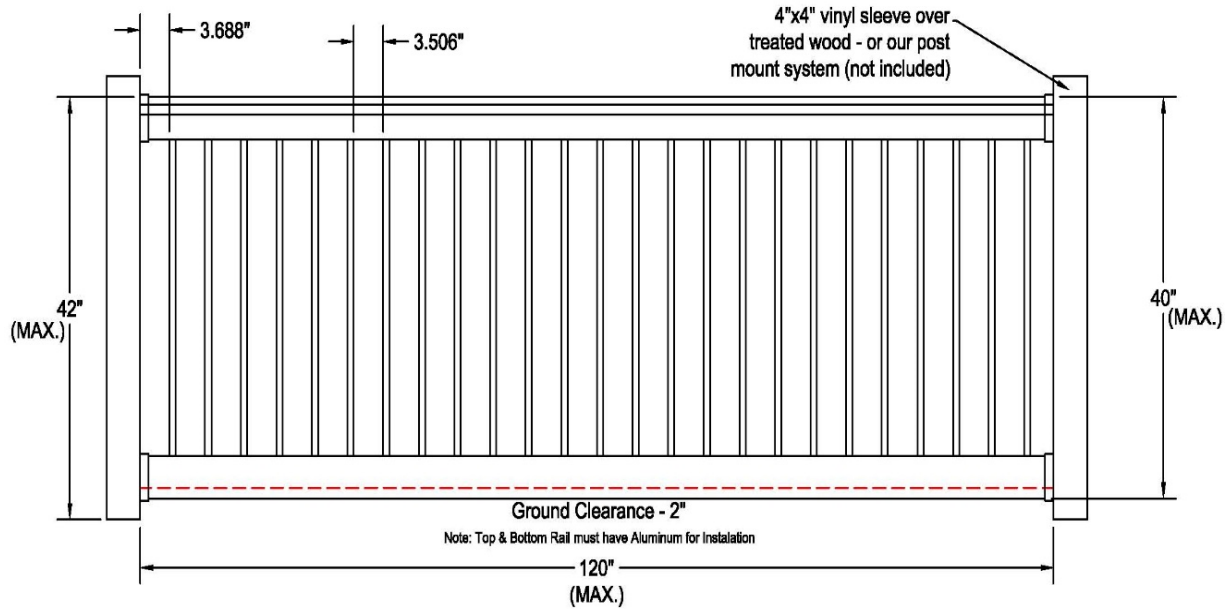

Top T-Rail with Aluminum reinforcement

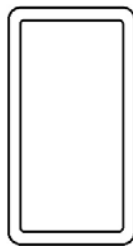

2" x 3.5" Vinyl Bottom Rail

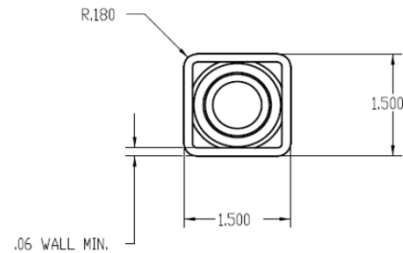

**1.50" x 1.50" Thermo-Formed
Spindle (No. 3005) (WXR-T42-C8/10)**

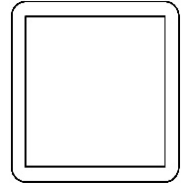

**1.5" x 1.5" Co-Extruded PVC
Baluster (WXR-T42-S8/10)**



1.5" Foot Block

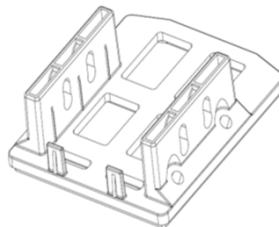

LMT Bracket 1520-WP

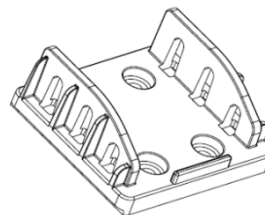

Alternative LMT Bracket 1422-CM

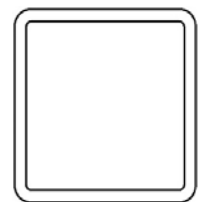

**4" x 4" Co-Extruded
PVC Plastic Sleeve**

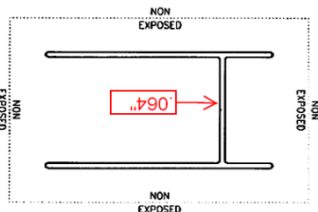

**.065" Aluminum Reinforcement
(1422-CM Bracket)**

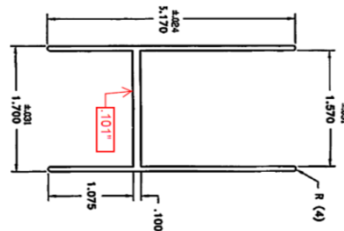

**.100" Aluminum Reinforcement
(1422-CM Bracket)**

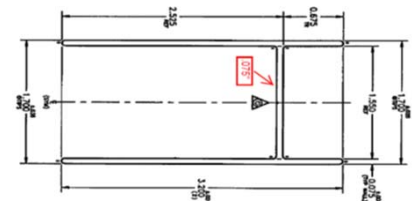

.075" Aluminum Reinforcement (1520-WP Bracket)

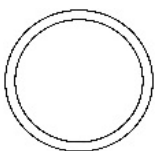

3/4" Round Aluminum Baluster
(WXR-T42-R8/10)

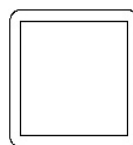

**3/4" x 3/4" Suare Aluminum
baluster (WXR-T42-A8/10)**

Note: CAD's will be different per the different railing styles, since the measurements and spacing are all different for each baluster style.

WXR-R42-A8(10), WXR-R42-C8(10), WXR-R42-R8(10), WXR-R42-S8(10)

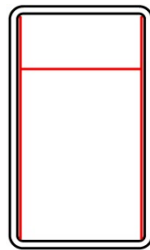
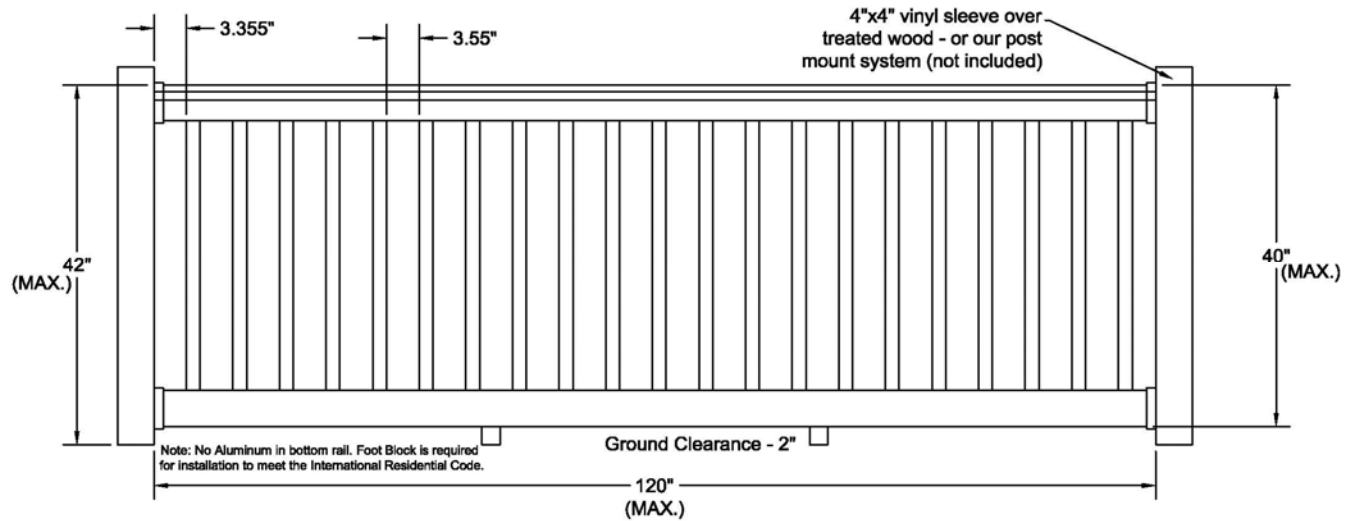

Top Rail with Aluminum reinforcement

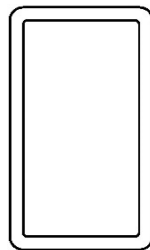

2" x 3.5" Bottom Rail

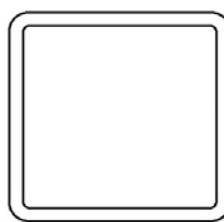

4" x 4" Vinyl Sleeve (Opt)

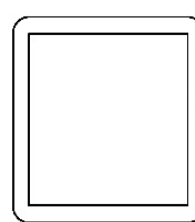

1.5" x 1.5" Co-Extruded PVC Baluster (WXR-R42-S8/10)

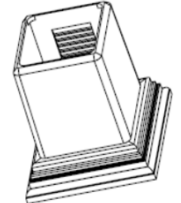

1.5" Footblock

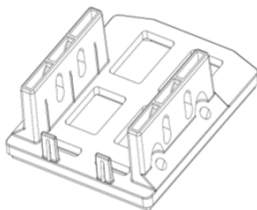

LMT Bracket 1520-WP

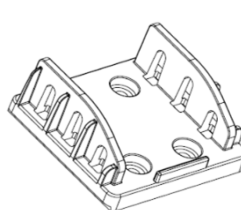

LMT Bracket 1422-CM

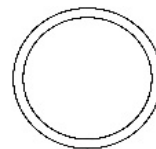

3/4" Aluminum Baluster (WXR-R42-R8/10)

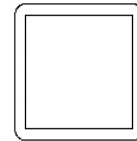

3/4" x 3/4" Square Aluminum baluster (WXR-R42-A8/10)

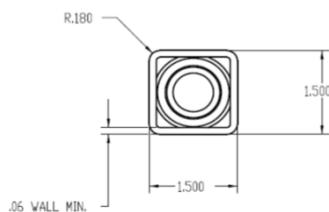

1.50" x 1.50" Thermo-Formed Spindle (No. 3005) (WXR-R42-C8/10)

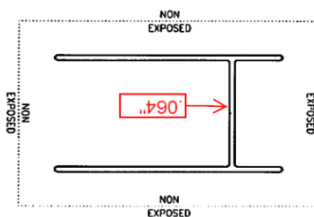

.065" Aluminum Reinforcement (1422-CM Bracket) WXR-R42-S8

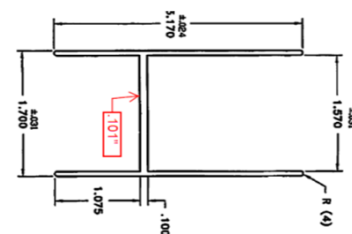

.100" Aluminum Reinforcement (1422-CM Bracket) WXR-R42-S10

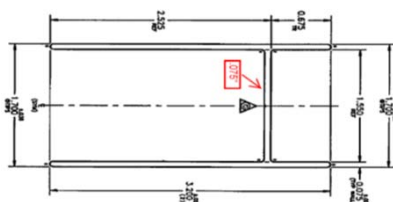

.075" Aluminum Reinforcement (1520-WP Bracket) (WXR-R42-R10)

Note: CAD's will be different per the different railing styles, since the measurements and spacing are all different for each baluster style.

WXR-R42-A8DB, WXR-R42-C8DB, WXR-R42-R8DB, WXR-R42-S8DB

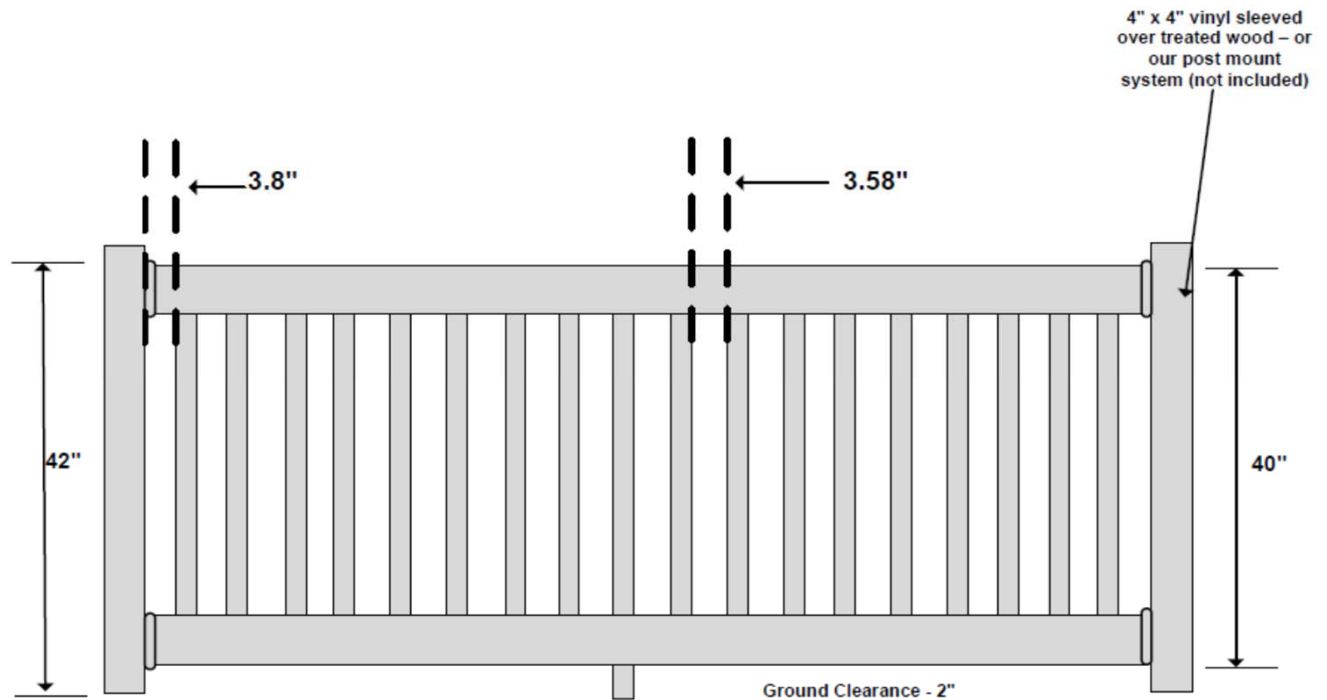

NOTE: No Aluminum in bottom rail. Foot Block is required for installation to meet the IRC/IBC codes.

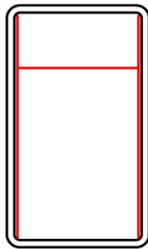

Top Rail w/Aluminum reinforcement

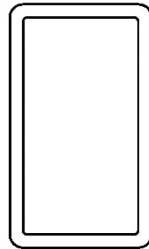

2" x 3.5" Bottom Rail

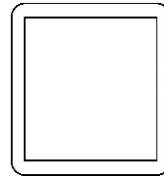

1.5" x 1.5" Co-Extruded PVC Baluster (WXR-R42-S8DB)

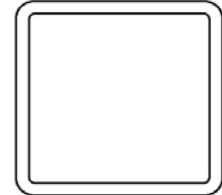

4" x 4" Vinyl Sleeve (Opt)

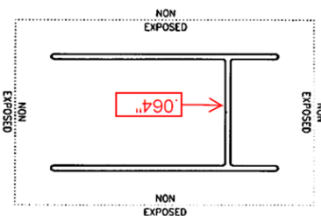

.065" Aluminum Reinforcement (1422-CM Bracket)

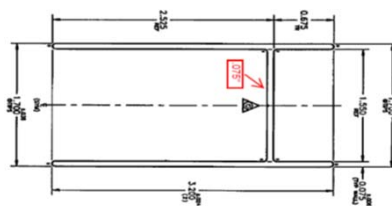

.075" Aluminum Reinforcement (1520-WP Bracket)

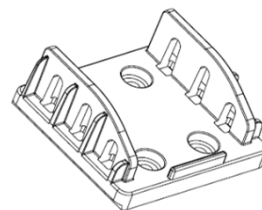

LMT Bracket 1422-CM

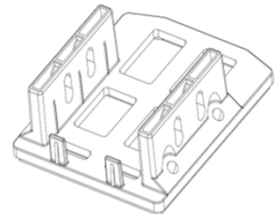

LMT Bracket 1520-WP

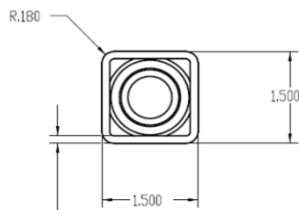

1.50" x 1.50" Thermo-Formed Spindle (No. 3005) (WXR-R42-C8DB)

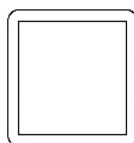

3/4" x 3/4" Square Aluminum baluster (WXR-R42-A8DB)

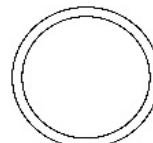

3/4" Aluminum Baluster (WXR-R42-R8DB)



Deck Board Clip

Note: CAD's will be different per the different railing styles, since the measurements and spacing are all different for each baluster style.

WXR-T42R3-S8, WXR-T42R3-S10

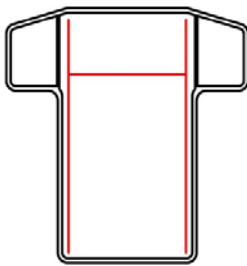
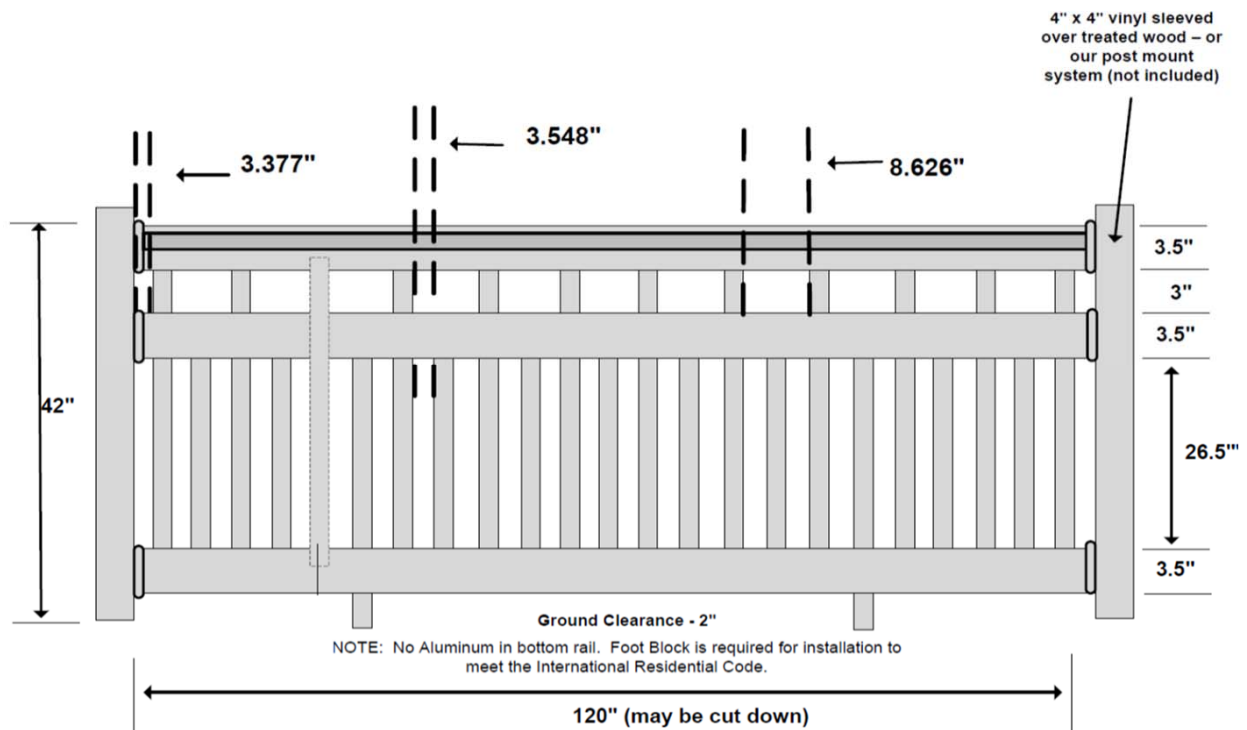

Top Rail w/Aluminum Reinforcement

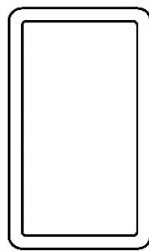

Middle & Bottom Rail

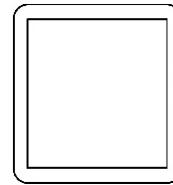

1.5" x 1.5" Co-Extruded PVC Baluster

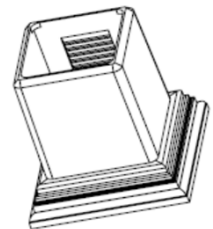

1.5" Footblock

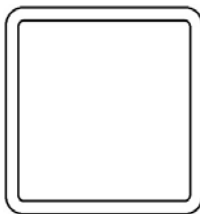

4" x 4" Vinyl Sleeve (OPT)

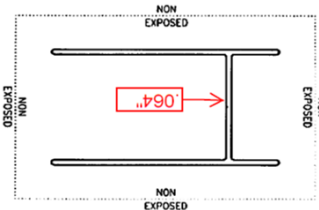

.065" Aluminum Reinforcement (1422-CM Bracket) 8-FT

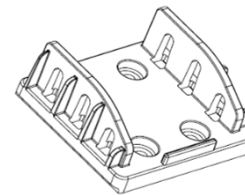

Alternative LMT Bracket 1422-CM

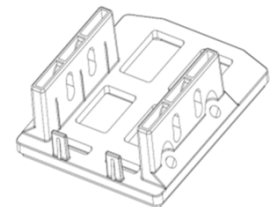

LMT Bracket 1520-WP

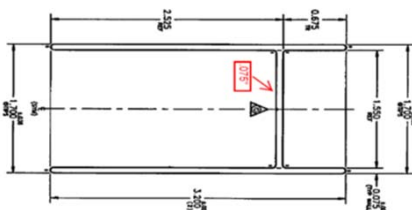

.075" Aluminum Reinforcement (1520-WP Bracket)

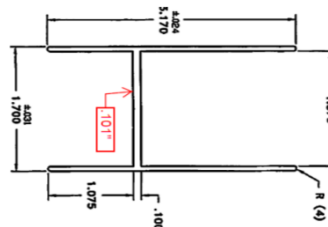

.100" Aluminum Reinforcement (1422-CM Bracket) 10-FT

Note: CAD's will be different per the different railing styles, since the measurements and spacing are all different for each baluster style.

CXR-R42-A8, CXR-R42-C8, CXR-R42-E8, CXR-R42-R8, CXR-R42-S8

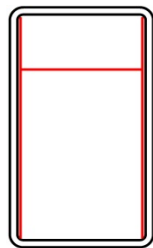
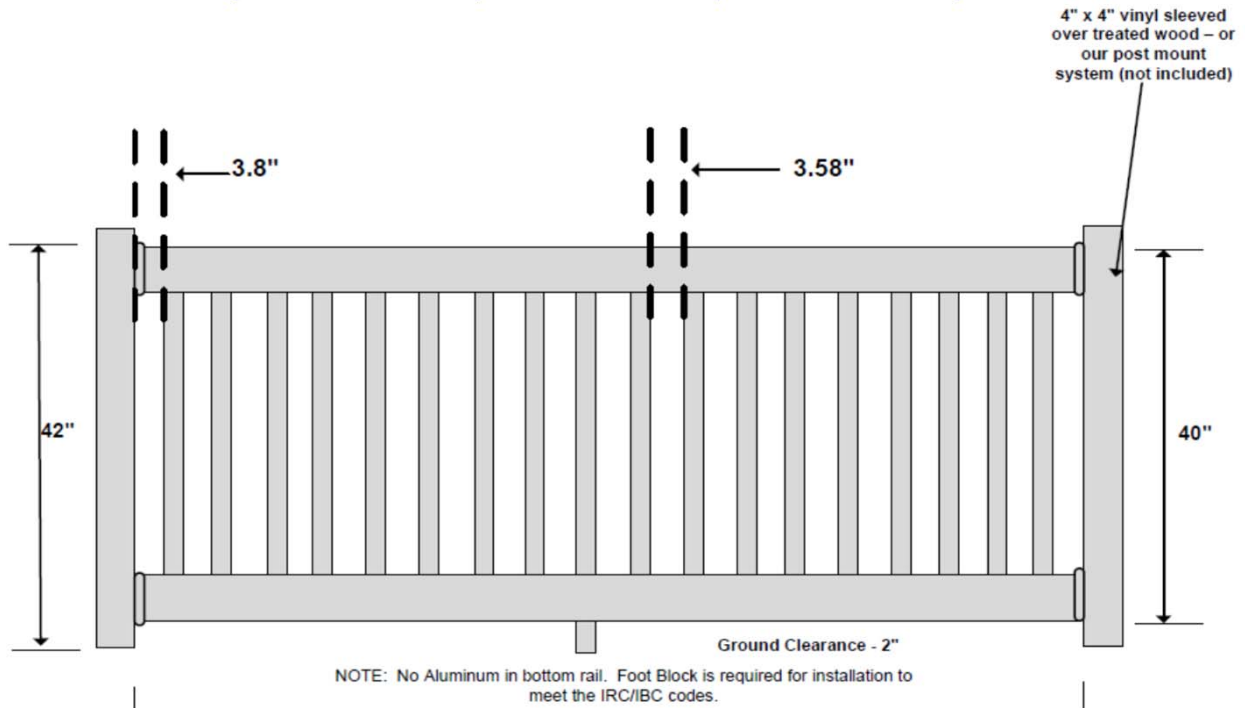

Top Rail w/Aluminum Reinforcement

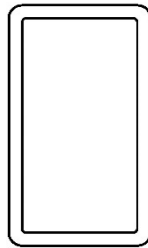

Bottom Rail

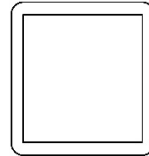

1.5" x 1.5" Co-Extruded PVC Baluster (CXR-R42-S8)

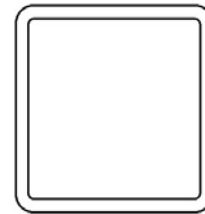

4" x 4" Vinyl Sleeve (OPT)

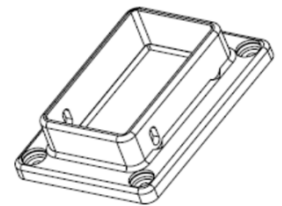

Top/Bottom Rail Bracket (LMT 1182)

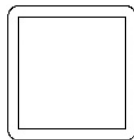

3/4" x 3/4" Square Aluminum baluster (CXR-R42-A8)

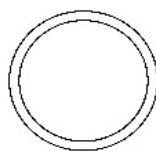

3/4" Aluminum Baluster (CXR-R42-R8)

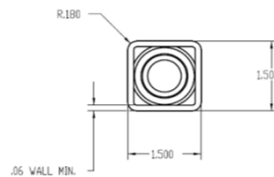

1.50" x 1.50" Thermo-Formed Spindle (No. 3005) (CXR-R42-C8)

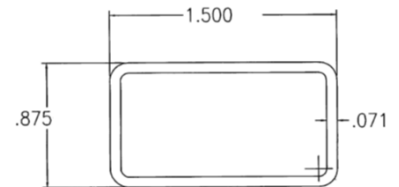

.875 x 1.5" Baluster (CXR-R42-E8)

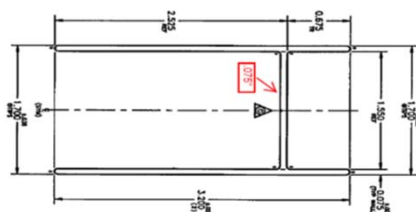

.075" Aluminum Top Rail Reinforcement

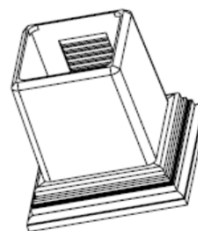

1.5" Footblock

Note: CAD's will be different per the different railing styles, since the measurements and spacing are all different for each baluster style.

CXR-T42-A8, CXR-T42-C8, CXR-T42-E8, CXR-T42-R8, CXR-T42-S8

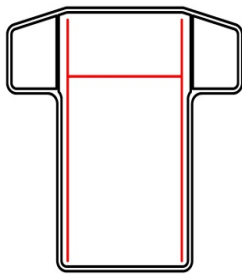
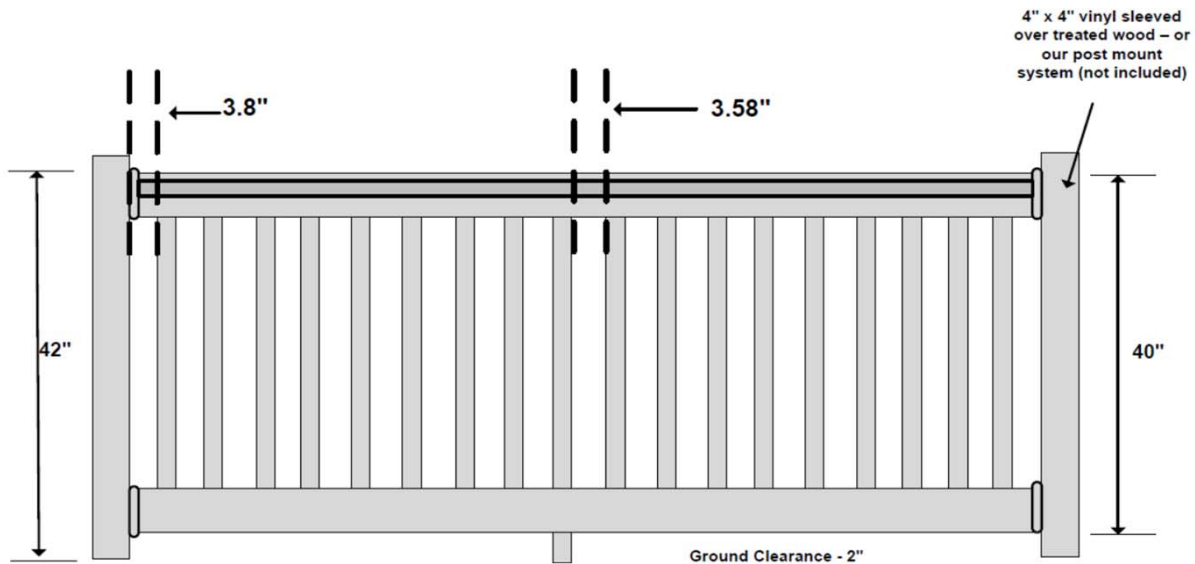

T-Rail w/Aluminum Reinforcement

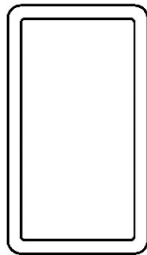

Bottom Rail

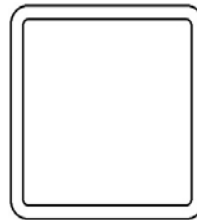

4" x 4" Vinyl Sleeve (Opt)

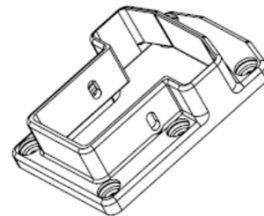

Top Rail Bracket

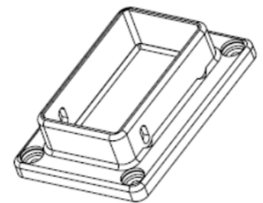

Top/Bottom Rail Bracket

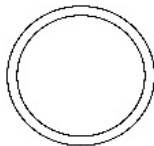

3/4" Aluminum Baluster (CXR-T42-R8)

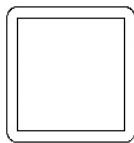

3/4" x 3/4" Square Aluminum baluster (CXR-T42-A8)

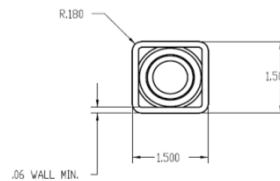

1.50" x 1.50" Thermo-Formed Spindle (No. 3005) (CXR-T42-C8)

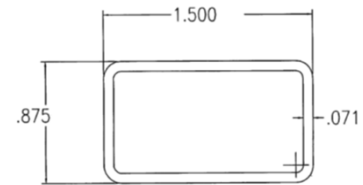

.875 x 1.5" Baluster (CXR-T42-E8)

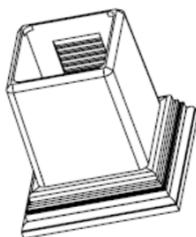

1.5" Footblock

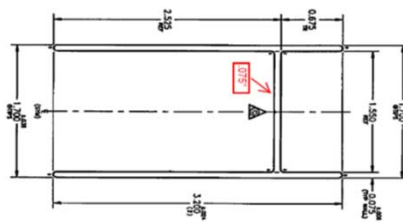

.075" Aluminum Top Rail Reinforcement

Note: CAD's will be different per the different railing styles, since the measurements and spacing are all different for each baluster style.

CXR-T42R3-S8

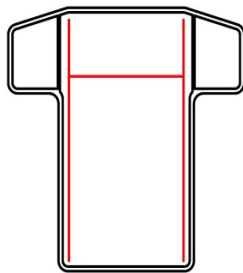
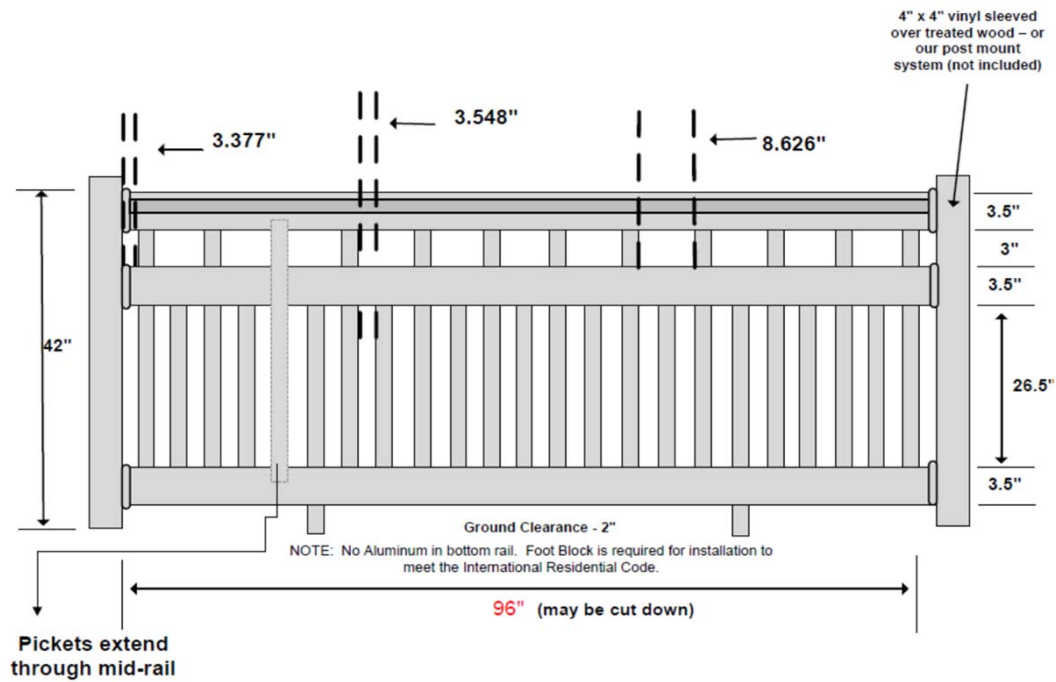

Top Rail w/Aluminum Reinforcement

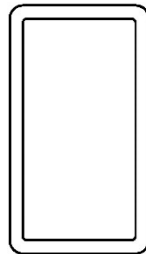

Middle & Bottom Rail

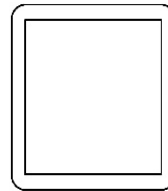

1.5" x 1.5" Co-Extruded PVC Baluster

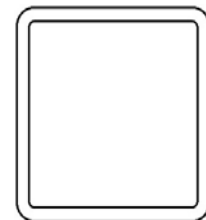

4" x 4" Vinyl Sleeve (OPT)

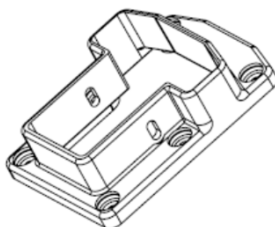

Top Rail Bracket (LMT 1182)

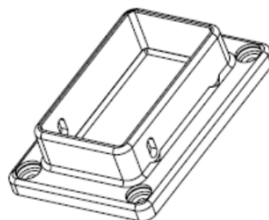

Top/Bottom Rail Bracket (LMT 1219)



(LMT 1.5" Footblock

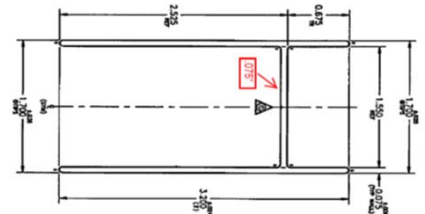

.075" Aluminum Reinforcement

Note: CAD's will be different per the different railing styles, since the measurements and spacing are all different for each baluster style.

Tested to

ASTM D7032-17a - Standard Specification for Establishing Performance Ratings for Wood Plastic Composite Deck Boards and Guardrail Systems

ASTM G 154-00 - Operating Fluorescent Light Apparatus for UV Exposure of Nonmetallic Materials

Product Labeling

The Guardrail Systems must be labeled with at least the following information:

1. The Guardrail Name
2. Date Code
3. Manufacturer Name, Logo or Website
4. This **PER** Number & *Pei* **ES** Name or Logo

Acceptable Evaluation Marks**Product Documentation**

A Product Evaluation Service Agreement between *Pei Evaluation Service*® and **USA Vinyl, LLC**

A Follow-up Inspection Service Agreement between *Progressive Engineering Inc.* and **USA Vinyl, LLC**

A *Pei Evaluation Service*® Agreement between **PER** Owner and Approved Manufacturer

USA Vinyl Railing Program Quality Manual - Dated: **7/1/2019**

Weatherables Classic Vinyl Railing - Installation Guide - **USA Vinyl, LLC**

Weatherables Premium Vinyl Railing - Installation Guide - **USA Vinyl, LLC**

3-Piece Bracket System Installation Instructions - From LMT Mercer Group Inc.

A SDS sheet for PVC Compounds - Dated: 10/31/2015

Pei test report No. 2013-0353 (A) - ASTM D7032 Guardrail Tests - Dated: March 4, 2013

Pei test report No. 2013-0353 (B) - ASTM D7032 Guardrail Test on a 8' Berkshire Railing System - Revised: December 15, 2015

Pei test report No. 2013-0353 (C) - ASTM D7032 Guardrail Test on a 10' Washington Railing System - Revised: January 21, 2014

Pei test report No. 2013-0353 (D) - Perform ASTM D7032 UV Resistance Testing on Three (3) Colors for USA Vinyl- Revised: August 27, 2013

Pei test report No. 2013-1365 Addendum A - 10' Birmingham Railing Tests - Dated: January, 2014

Pei test report No. 2013-1365 Addendum B - 10' Wilshire Railing Tests - Dated: January, 2014

Pei test report No. 2014-0537 - 4" Sphere Passage Test on Colonial Spindles in an Addison Railing System - Dated: March, 2014

Pei test report No. 2015-1235 - ASTM D7032 Guardrail Test on a 8' Classic Railing System (IRC) with a .075" Thick Aluminum Rail Reinforcement - Dated: October 27, 2015

Test Report No. 67969.01-119-19 ICC-ES AC174 (effective July 1, 2006), Acceptance Criteria for Deck Board Span Ratings and Guardrail Systems Section 5.0 and 5.2

Test Report No. 77831.02-119-19 ICC-ES AC174 (effective March 1, 2007), Acceptance Criteria for Deck Board Span Ratings and Guardrail Systems (Guards and Handrails)

Pei test report No. 2020-6140 (A) - ASTM D7032 Guardrail Test on a 10' Berkshire Railing System with a .100" Thick Aluminum Rail Reinforcement - Dated: July 10, 2020, Revised on August 5, 2020.

Pei test report No. 2020-6140 (B) - ASTM D7032 Guardrail Test on a 8' Berkshire Railing System with a .065" Thick Aluminum Rail Reinforcement - Dated: July 10, 2020, Revised on August 5, 2020.