

SELF-CLOSING ORNAMENTAL HINGE INSTALLATION INSTRUCTIONS

PLEASE CAREFULLY READ ALL INSTRUCTIONS PRIOR TO INSTALLATION.

MAX GATE WEIGHT: 75 LBS.

GATE GAP: 1/4"

Tools Needed:

- Tape measure & pencil
- Drill with 1/8" drill bit
- 8mm hex head bit
- Level

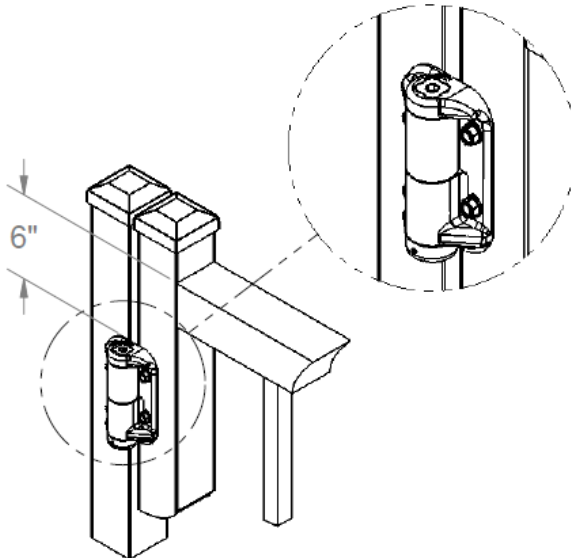

1. Measure and place the hinges on the gate and fence post.
 - Use a 1/8" drill bit to make pilot holes for the screws.
 - The hinges should be positioned on the outside surfaces of the posts with the gate in the closed position.
 - The top edge of the upper hinge should be mounted within 6" of the top of the gate.
 - The bottom edge of the lower hinge should be within 6" of the bottom of the gate.

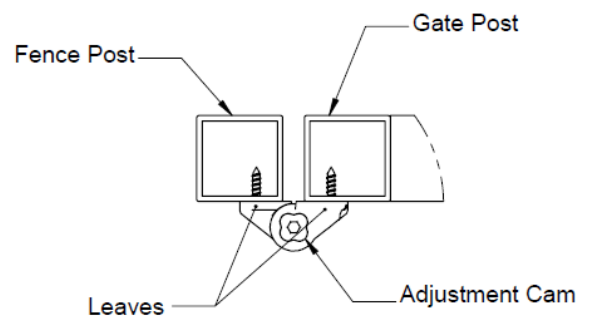

2. Secure the hinges with the 1-1/4" hex-head screws.
 - Use a level to assure the gate is straight and level before installing.

SPRING TENSION ADJUSTMENT AND MAINTENANCE

IMPORTANT: Spring tension should never be increased more than 2 full turns (8 quarter turns) from the neutral position.

1. Insert the included allen wrench into the cam at the end of the hinge barrel. Press the wrench downward, pushing the cam into the barrel. Rotate the cam clockwise to increase spring tension and counterclockwise to reduce spring tension. Adjust one hinge at a time in 1/4 turn increments.

NOTE: Inspect the hinge periodically to assure the fasteners stay tight and the gate does not sag. Spring tension adjustments should be made as needed. The hinge should be regularly lubricated with an oil based lubricant by spraying into the cams and barrel.

